

## Manufacturer's Declaration of Conformity

This product has been manufactured in accordance with the harmonized European standards, following the provisions of the below stated directives:

	93/42/EEC as amended by 2007/47/EC Medical Device Directive
--	--

*Please see separate document showing on sticker of device for above CE marking.*

### Authorized EU Representative:



**Wellkang Ltd**  
Suite B, 29 Harley Street  
LONDON, W1G 9QR, U.K.

### Manufactured by:



**Charder Electronic Co., Ltd.**

No.103, Guozhong Rd., Dali Dist.,  
Taichung City 412, Taiwan (R.O.C.)

FDA no.:D072478 / 3007074192

IN-1371[15245A] 10/2015

**charder**®

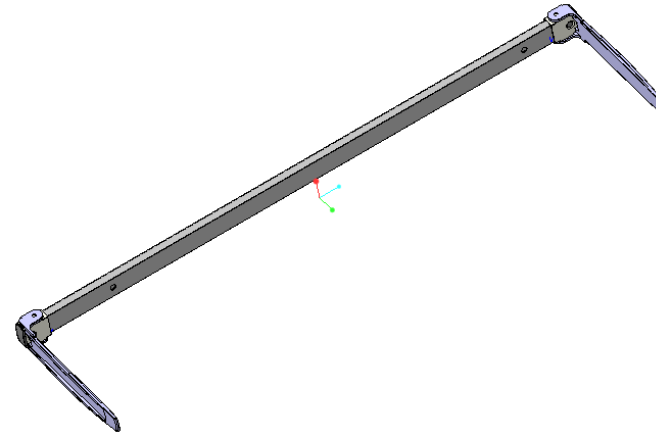

# HM 101M

## Height Measurement

## USER MANUAL



*Please keep the instruction manual at hand all the time for future reference.*





Ensure that the height measuring rod may only come into contact only with uninjured skin.

### Improper Use

The structure of the height measuring rod may not be modified. This may result in incorrect measuring results, safety-related defects as well as destruction.

The height measuring rod may only be used according to the described conditions.



### Safety Instructions

- Observe operating instructions.
- Please use no other than the supplied fixtures for mounting.
- During assembling, ensure that screws are tightened properly and that the height measuring rod has been assembled correctly.
- To prevent risk of injury, ensure that the head stop is returned to folded-in position after each use.
- The body height measuring emits only reliable values, when the back and the head are straightly aligned, nevertheless the body height of a person may change about some cm during a day.
- Never leave a baby on the surface unsupervised
- When sliding the rod, ensure that baby is safely on the measuring area.

3. Fasten the rod on the wall.

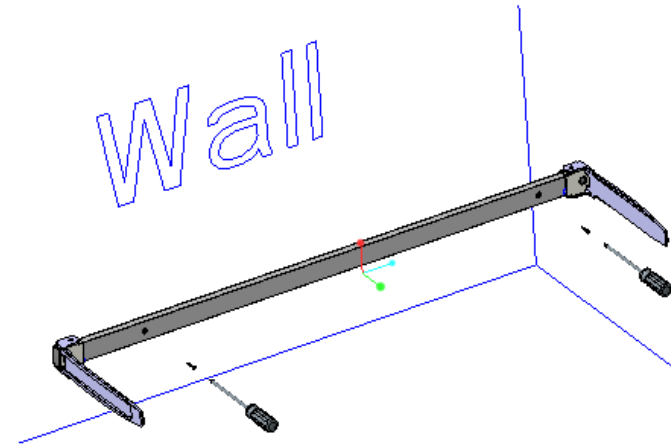

4.

3. Keep the baby on the surface with the left hand gently.
4. Gently press baby's knees down and push right head stop to the sole of the baby's feet.
5. Read off the length of the baby from HM101M height marking.

## SPECIFICATION

Measuring Range: 100mm ~ 1000mm

Graduation: 1mm

Accuracy:  $\pm 10$ mm

Dimension: 1020(W) x 50(H) x 275(D)mm

Weight: approx. 520g

Operation temperature: 5°C / 35°C

## HM101M WALL MOUNTED INSTRUCTION

1. Mark and drill two holes on the wall according to the hole-positions on the rod. Make sure two holes are on the same level.

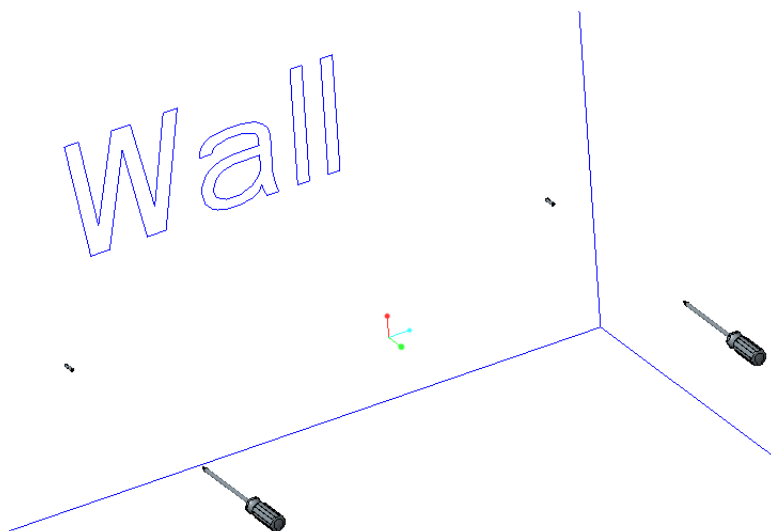

2. Press wall anchors into the holes.

## WARRANTY

A two-year warranty from date of delivery applies to defects attributable to poor materials or workmanship. Defects, which come under warranty, will be made good for the customer at no charge on production of the receipt. No further claims can be entertained. The costs of transport in both directions will be borne by the customer should the equipment be located anywhere other than the customer's premises. In the event of transport damage, claims under warranty can be honored only if the complete original packaging was used for any transport and the device secured and attached in that packaging just as it was when originally packed. All the packaging should therefore be retained.

A claim under warranty will not be honored if the equipment is opened by persons not expressly authorized by CharDer to do so. We would ask our customers abroad to contact their local sales agent in the event of a warranty matter.

PLEASE VISIT [WWW.CHARDERMEDICAL.COM](http://WWW.CHARDERMEDICAL.COM) FOR MORE INFORMATION.

## SETTING UP HM101M

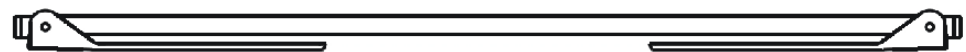

Place HM 101M on stable surface.

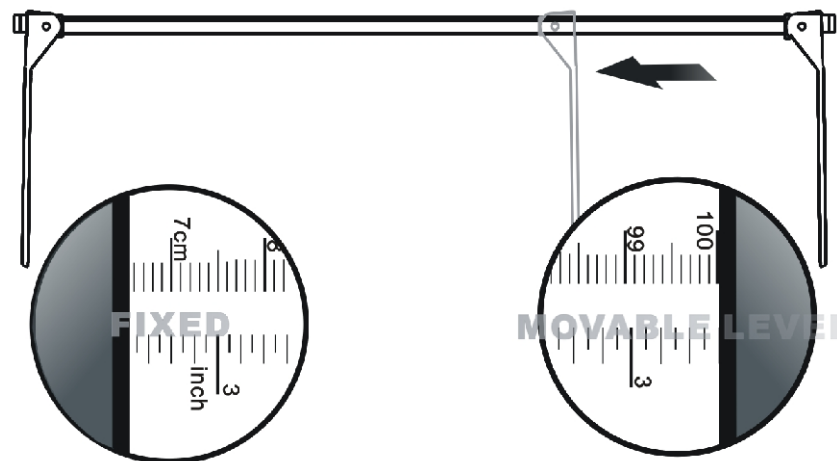
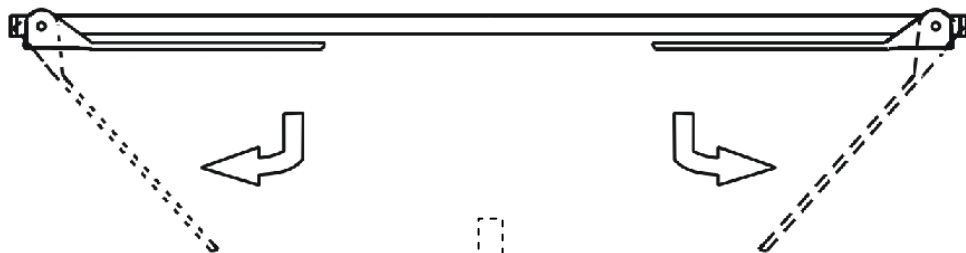

Measurement range is from 100mm to 1000mm

Push head stop to measure the length of baby.

## HOW TO MEASURE YOUR BABY

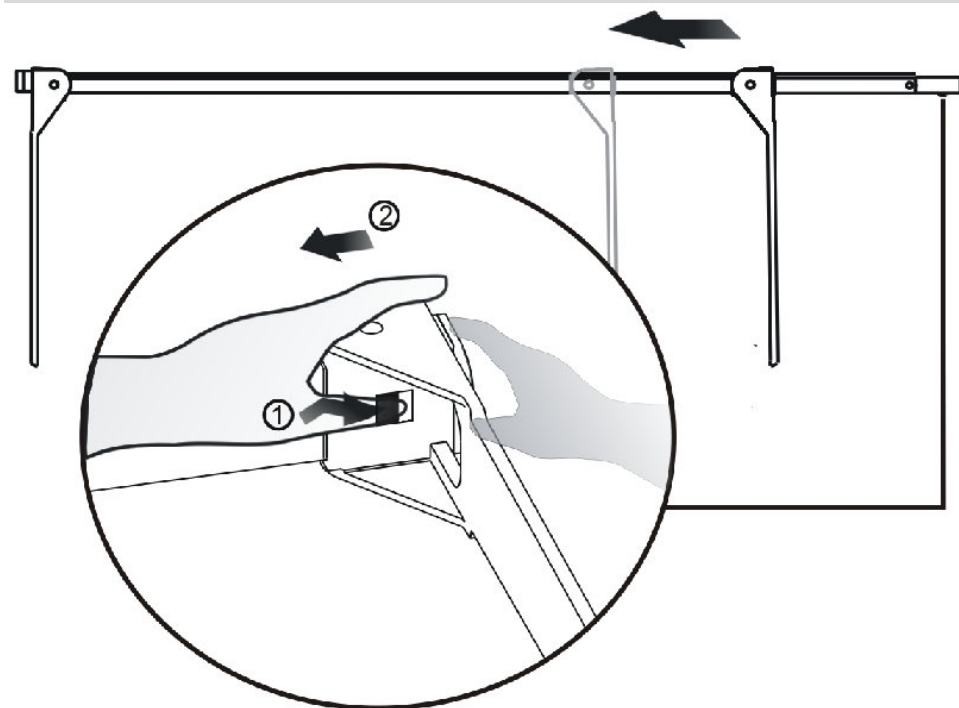

1. Push the buckle to release right head stop with your left hand.
2. Using your right hand to push head stop in the direction of baby's feet.

